

LT Type On-off rotary switch, 20A 250-400V

Unless exceptionally specified by this logo, products and components in this catalogue are made by Ultimheat alliance members.

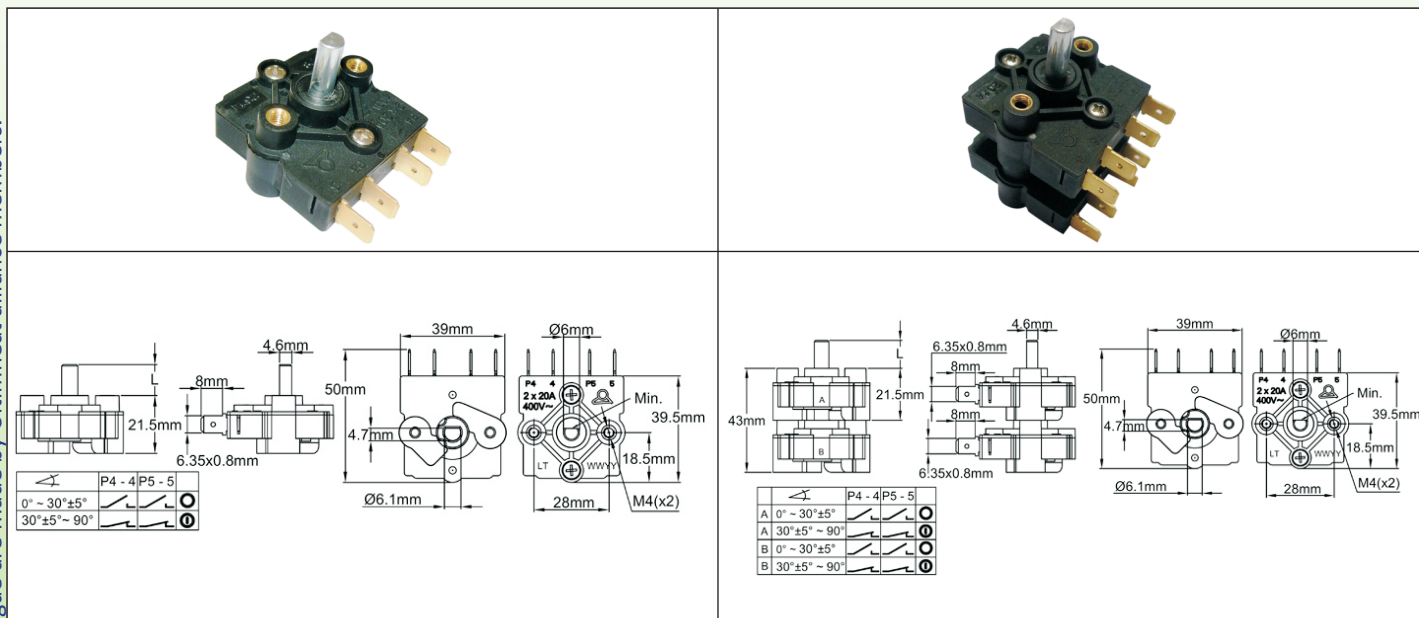

These on-off switches are designed for heater power switching. They are available in single pole contact, two pole (one level) and three pole or four-pole contact (two levels).

Main features

- Installation:** two M4 screws 28mm distance.
- Shaft lengths available:** 11.5; 15; 23mm
- Shafts:** Galvanized steel
- Electrical rating:** 20A 250/ 400V res. , 6000 cycles
- Rotation:** 90° on-off angle
- Operation diagram:** the contacts are closed between 0° and 30° +/- 5° angular and open between this value and 90°. There are stops at the 0 and 90° angle.
- Contact clearance:** between 0 and 20° angle, the contact spacing is greater than 3mm.
- Temperature:** 85°C
- Case Material:** PA66, UL94 VO
- Connection:** 6.35x0.8 tabs. Screw terminals available (MOQ)
- Options:** change of flat position, different contact opening or closing - positions

Main references with 6.3 tabs*

Switches	L=11.5mm	L=15mm	L=23mm
1	LT12190609060160	LT15190609060160	LT23190609060160
2	LT12290609060160	LT15290609060160	LT23290609060160
3 (2 levels)	LT12390609060160	LT15390609060160	LT23390609060160
4 (2 levels)	LT12390609060160	LT15390609060160	LT15390609060160

*Screw terminals option: replace 60 by V0 on the last 2 numbers in the product reference

Footprint with screw terminals

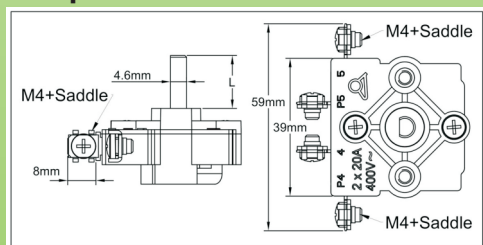

Accessories :

<p>Soft grip On-Off knob, black , white printed, dia 41mm</p> <p>Reference 66MZ006000037AW</p>	<p>Black bezel with arrow.</p> <p>Reference 66EN1</p>		

Because of permanent improvement of our products, drawings, descriptions, features used on these data sheets are for guidance only and can be modified without prior advice